

POWERTEC®

STRENGTH

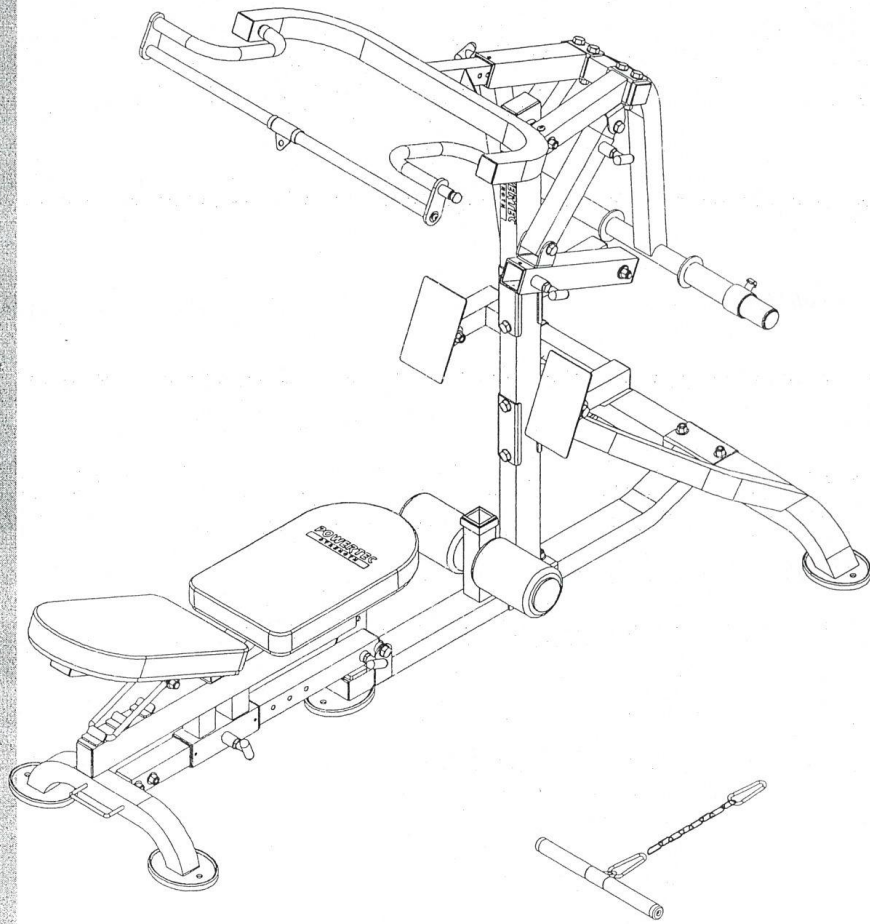

L-CG11



Manual







LEVERGYM COMPACT GYM

HARDWARE LIST

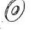
 31 3/8"x1-1/2" 2pcs  41 1/2"x2-1/2" 2pcs  52 1/2"x3-1/2" 1pc

 54 1/2"x3-3/4" 4pcs  55 3/8"x3/4" 8pcs  58 1/2"x16 28pcs

 59 $\phi 14 \times \phi 28 \times 2.0$ 50pcs  60 1/2"x4-1/8" 5pcs  61 1/2"x4-1/4" 2pcs

 62 1/2"x2-3/4" 2pcs  63 1/2"x3-1/8" 6pcs

L-CG11

ENERGY COMPACT

PART LIST

Part Description	QTY	Part Description	QTY
1 Front base tube	1	46 Square inner plug	4
2 Rear base tube	1	47 Square inner plug	10
3 Horizontal tube	1	48 Square inner plug	1
4 Rotating tube	1	49 Collar	2
5 Support tube	1	50 T spring pin	1
6 Support tube	1	51 T knob	2
7 Linkage frame	1	52 1/2**3-1/2' Half thread hex bolt	1
8 End cap	2	53 Bracket	2
9 Support tube	1	54 1/2'-3-3/4' Half thread hex bolt	4
10 Base tube	1	55 3/8**3/4' Hex bolt	9
11 Main frame	1	56 Axis	1
12 Back adjustment tube	2	57 PVC sleeve	2
13 Backrest tube	2	58 Nylon nut	28
14 Sliding tube	1	59 Washer	50
15 Foam tube	1	60 1/2**4-1/8' Half thread hex bolt	5
16 Adjustment tube	1	61 1/2**4-1/4' Half thread hex bolt	2
17 Roller foam	2	62 1/2**2-3/4' Half thread hex bolt	2
18 Rotating tube	1	63 1/2**3-1/8' Half thread hex bolt	6
19 Foot plate	2	64 Round inner plug	1
20 Weight support tube	1	65 Round inner plug	2
21 Handle bar	1	66 Square inner plug	2
22 Brackrest pad	1	67 Washer	1
23 Bracket	1	68 Chain	1
24 Lower lat bar	1	69 Square inner plug	2
25 Handle tube	1	70 Screw	2
26 Brackrest pad	1	71 T Spring pin	1
27 Upright	1		
28 PVC Sleeve	2		
29 Cap	2		
30 Footplate	5		
31 T spring pin	1		
32 3/8**1-1/2' Half thread hex bolt	2		
33 Spring pin	1		
34 Screw	4		
35 Bushing	2		
36 Bushing	1		
37 Bumper	1		
38 PVC Sleeve	2		
39 Snap link	2		
40 Rubber tube	2		
41 1/2'-2-1/2' Half thread hex bolt	2		
42 Bearing	2		
43 Metaling	10		
44 Metaling	2		
45 Bushing	2		

L-CG11

LEVERGYM COMPACT GYM

EXPLODED DIAGRAM

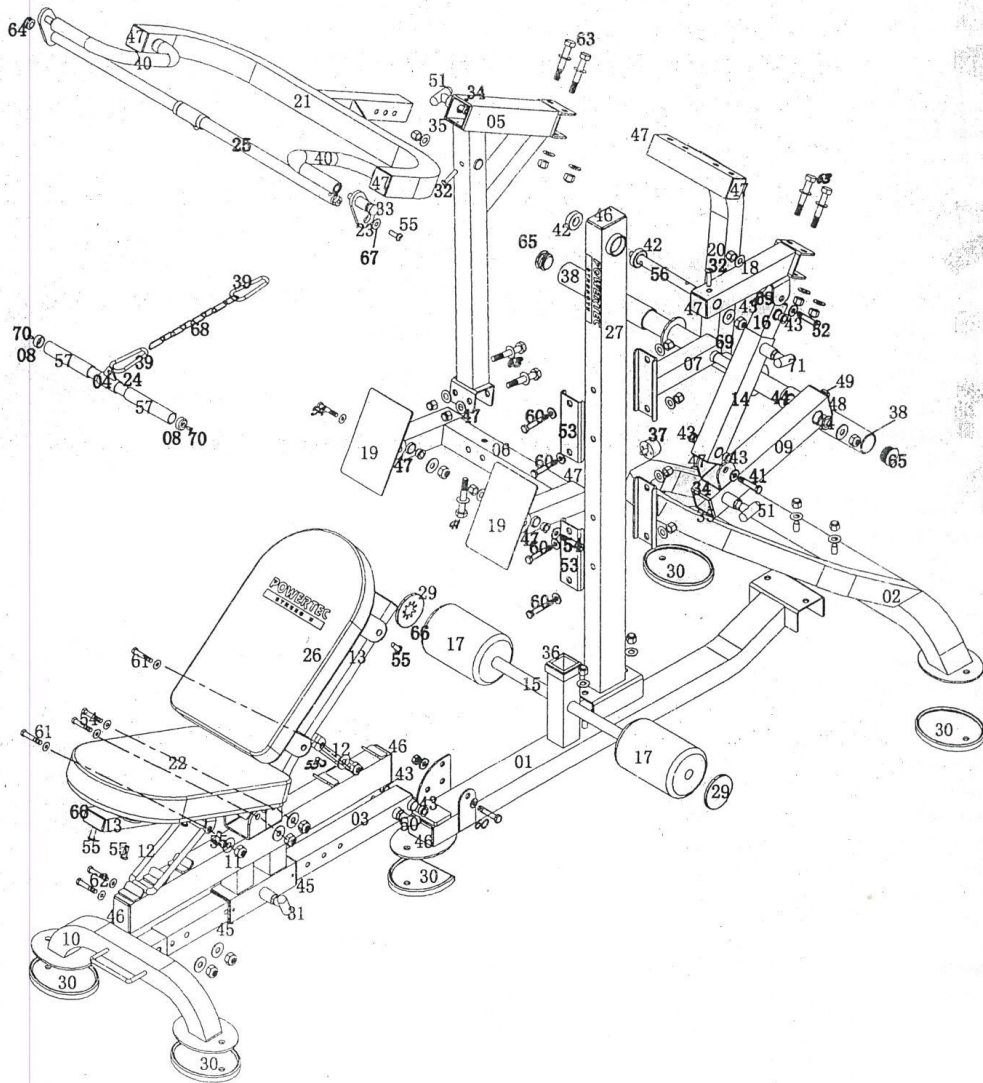

Remarks: All unmarked washers are (59) and all unmarked Nylon nuts are (58).

L-CG11

LEVERGYM COMPACT GYM

ASSEMBLY ONE

Note before beginning assembly:
*Always insert all bolts through holes prior to tightening
due to precision fit*

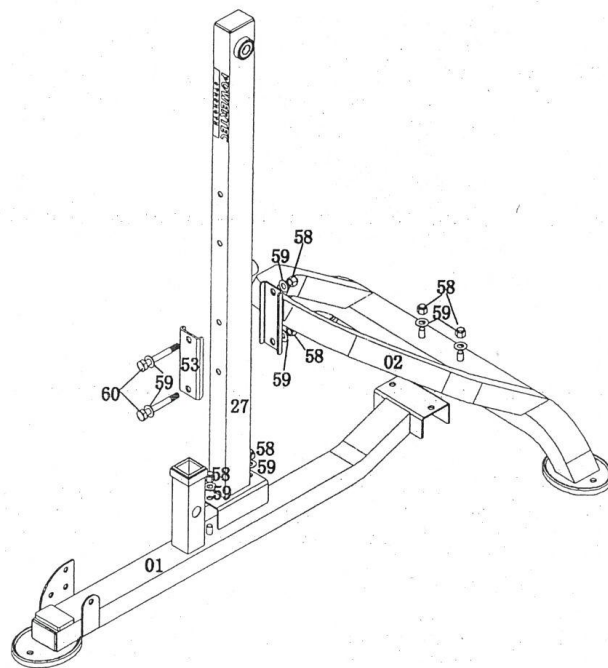

L-CG11

LEVERGYM COMPACT GYM

ASSEMBLY TWO

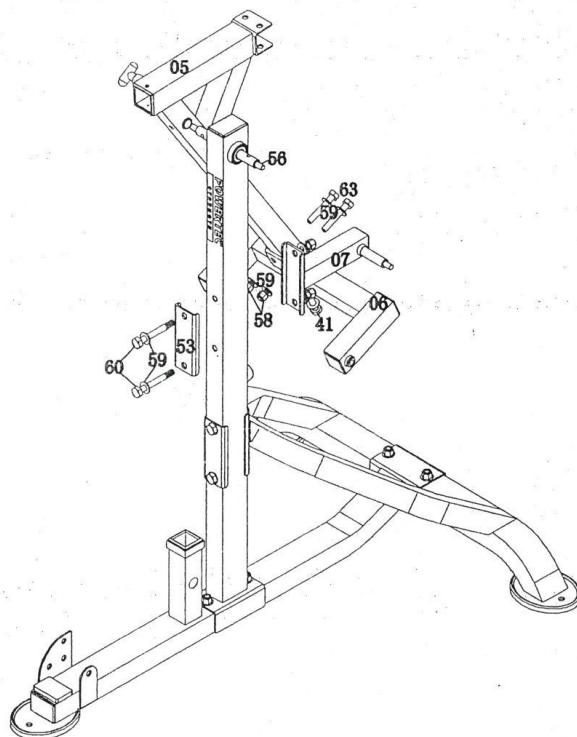

OVERTEC

L-CG11

LEVERGYM COMPACT GYM

ASSEMBLY THREE

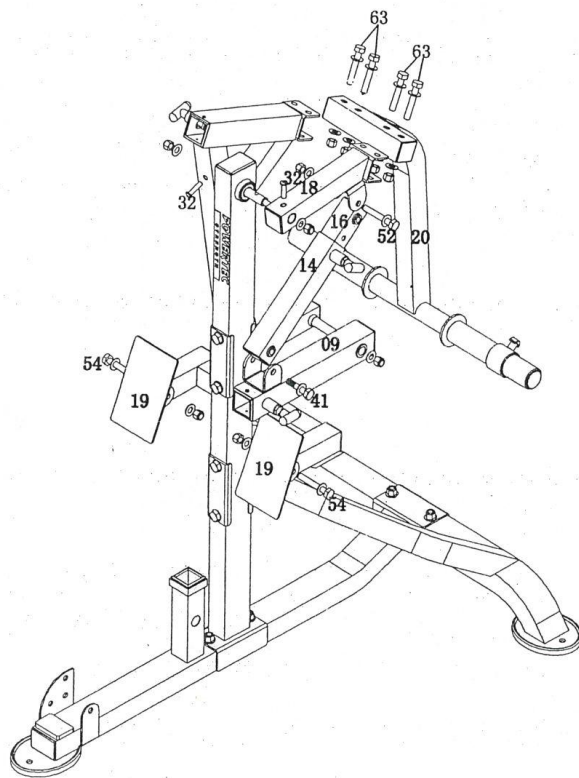

L-CG11

LEVERGYM COMPACT GYM

ASSEMBLY FOUR

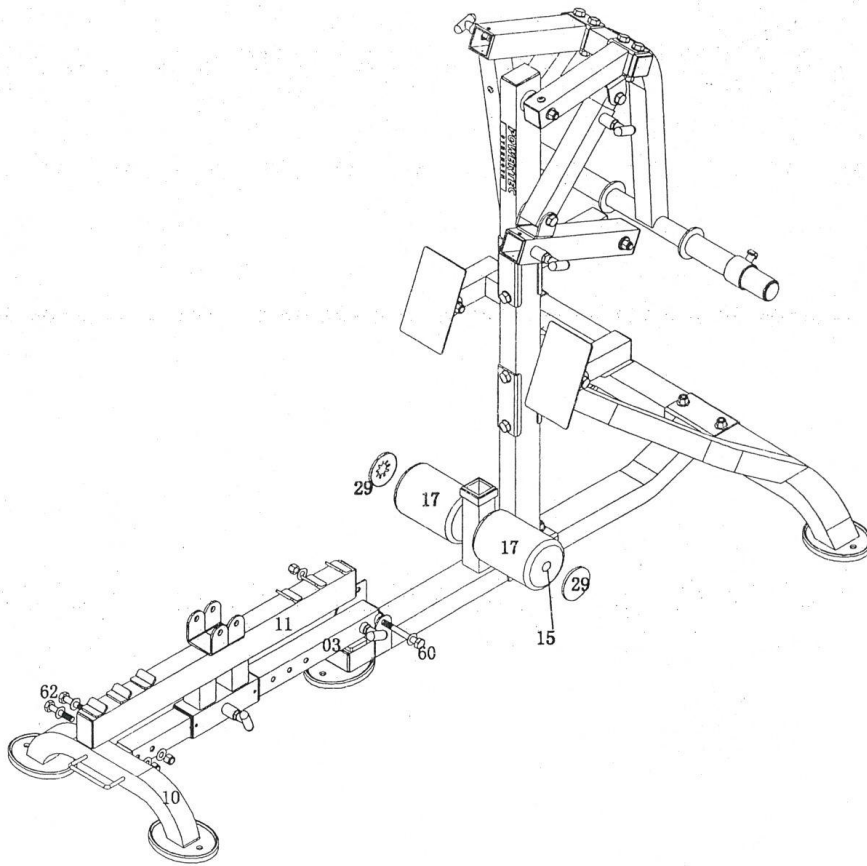

L-CG11

LEVERGYM COMPACT GYM

ASSEMBLY FIVE

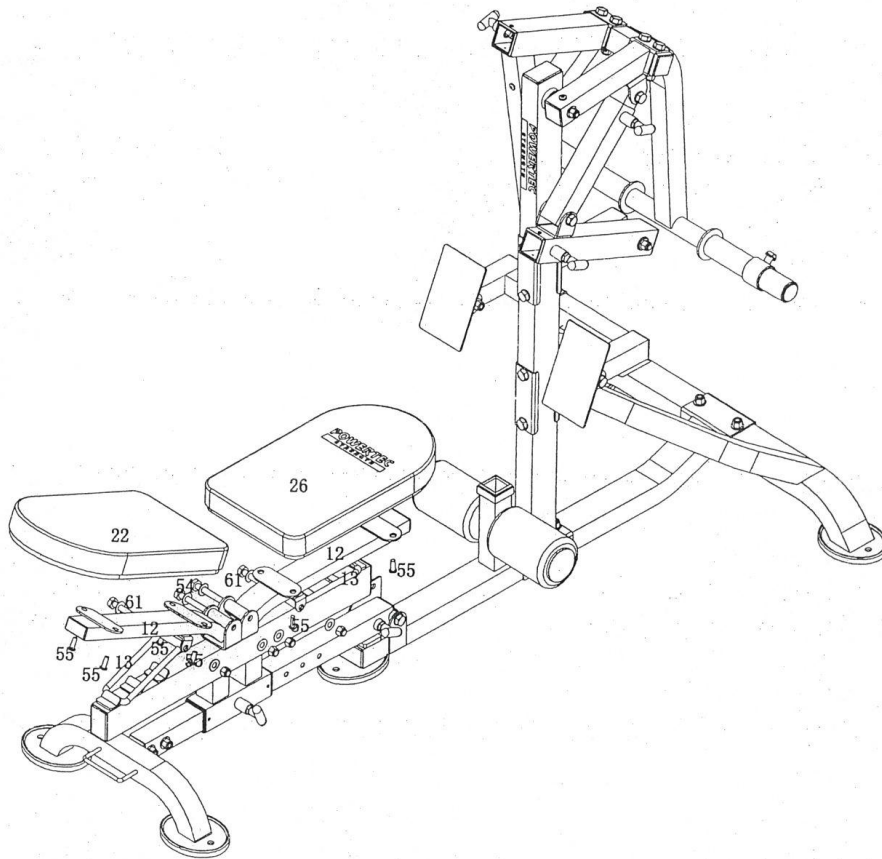

L-CG11

LEVERGYM COMPACT GYM

SPORTS
TECH
®

ASSEMBLY SIX

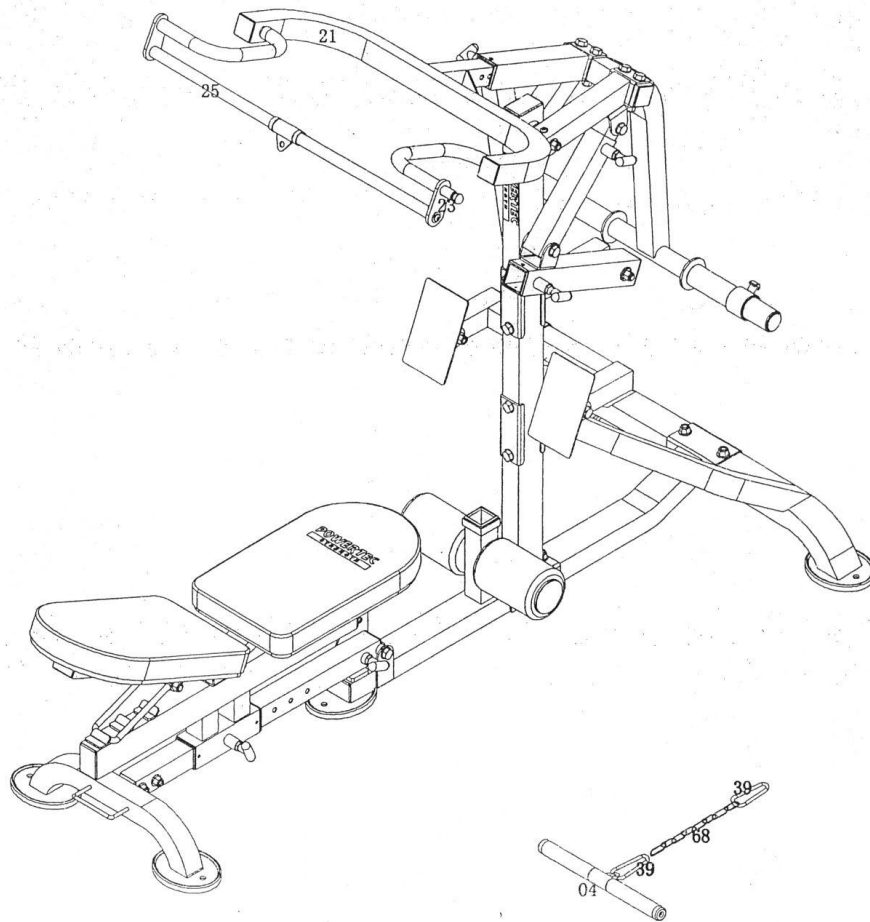

L-CG11

LEVERGYM COMPACT GYM

ADDITIONAL ASSEMBLY INSTRUCTION FOR COMPACT GYM



P01



P02

55

STEP 1:

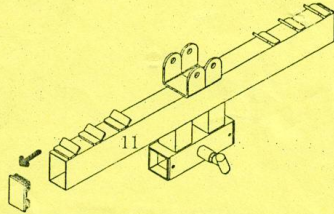

REMOVE PLASTIC CAP.

STEP 2:

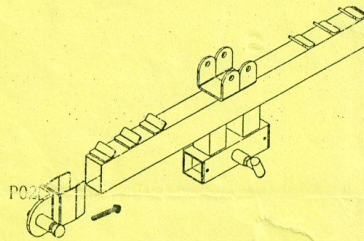

HAMMER THE METAL PIN INTO THE METAL TUBE GENTLY.

STEP 3:

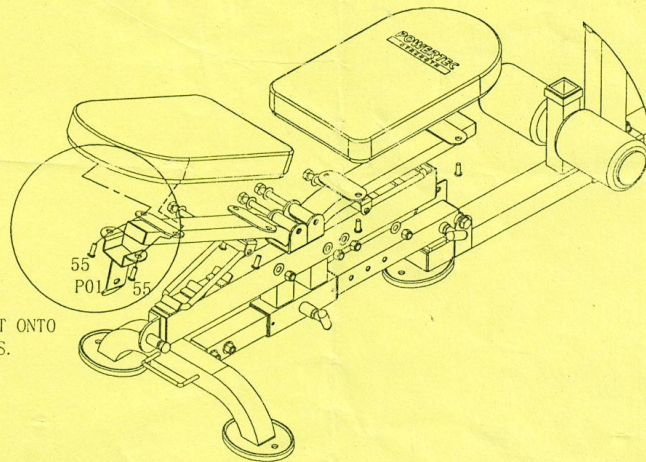

SCREW THE METAL INSERT ONTO
PAD BY TWO #55 SCREWS.